

BONNIE CASTLE

ADDITION TO THREE RIVERS

Scale one inch to 100 ft.

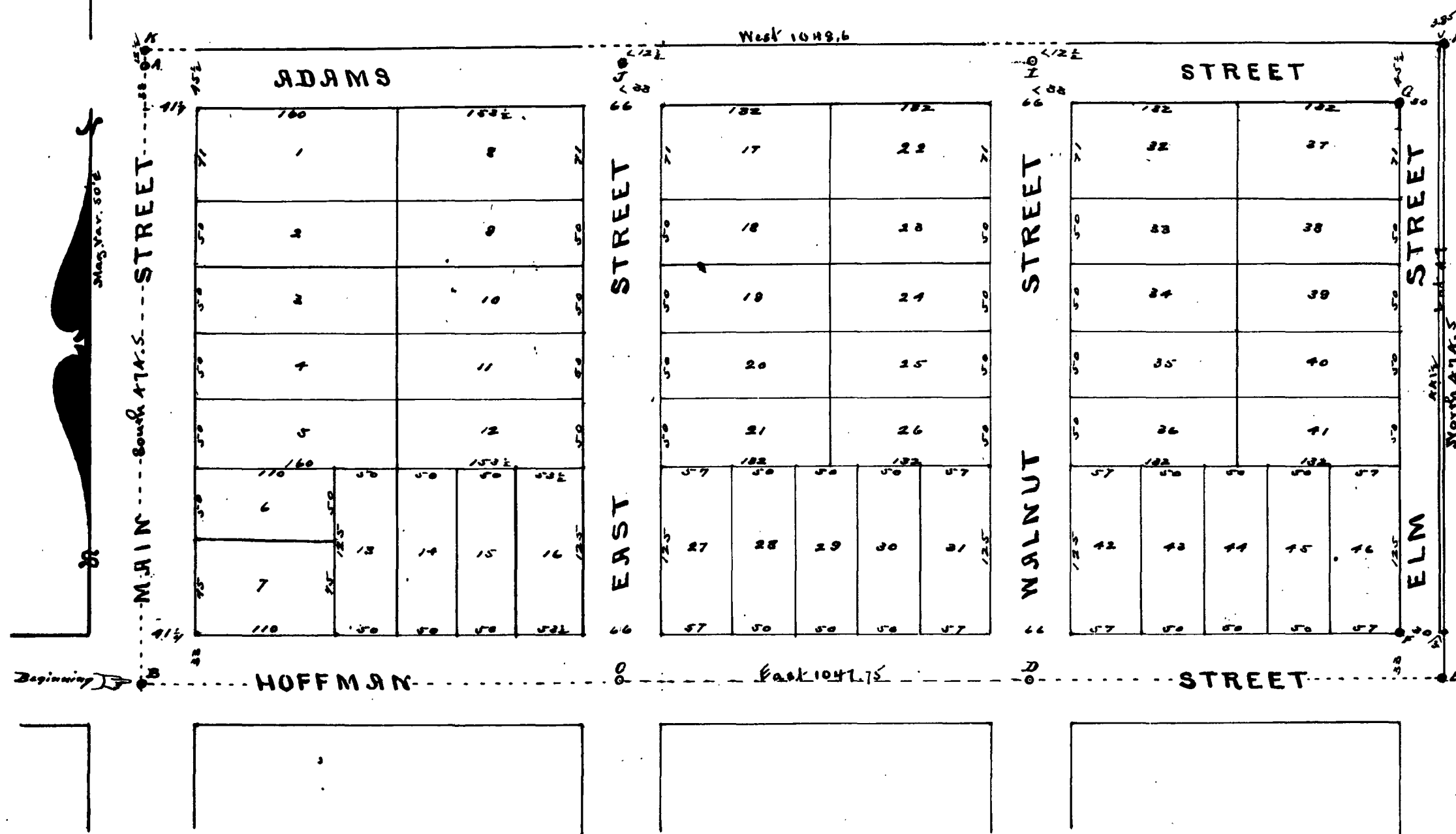

Description
A part of the south half of the south-west quarter of the south-east quarter of section seven, Town 6 south, Range 11 West, being in St. Joseph Co. Michigan and bounded by beginning at the quarter corner between sections seven and eighteen, thence east on the section line 1047.75 ft. to a stonerd, thence north 474.5 ft. to a gas pipe stake, thence west 1042.6 ft. to a gas pipe stake and thence south on the quarter line 474.5 ft. to stone at place of beginning.

I hereby certify that the plat hereon delineated is a correct one and that permanent monuments have been placed at points marked thus, (o) with small circles, the monuments at K, B, C, D and E are stonerd found in position, the monuments at F, G, H, I, J and K are gas pipe stakes.

Samuel S. Reed Engineer

Examined and Approved
March 16, 1907
John F. Wilkinson
Deputy Auditor General.

I have examined the plat in this application for the description of land, in the within instrument, and from such examination it appears that the facts and County taxes have been fully paid for the five years preceding the date of this instrument.

APR 17 1907

W. H. Van Buren
County Treasurer

Dedication
Know all Men by these Presents, that we Samuel S. Reed and Eliza T. Reed, husband and wife, and joint owners, as proprietors, have caused the land embraced in the annexed plat to be surveyed, laid out and platted to be known as Bonnie Castle Addition to Three Rivers, and that the streets as shown on said plat are hereby dedicated to the use of the public as follows; In East street and Walnut street 5 ft. on each margin of said streets shall be used for walks, the next 15 ft. on each side for tree planting and parking and the remaining 26 ft. in the center of each street shall be used for general road-way. In Elm St. the west 5 ft. shall be used for side walk, the next 10 ft. for tree planting and parking and the remaining 15 ft. on the east side of Elm St. shall be used exclusively for general road-way and vehicle traffic. In Adams street 4 ft. on each margin shall be used for walk purposes, the next seven ft. on each side shall be used for tree planting and parking and the remaining 23 1/2 ft. in the center of the street shall be used for general road-way. Its proprietors we reserve all property rights to water pipe now laid in Adams St. and the right to maintain the same, including the fire hydrant now set in said Adams St. We also as proprietors reserve the right for one year to grade Adams, Elm, Walnut and East Streets and remove the earth from the gutters in said streets.

Signed and sealed in presence of
L. O. Miller
Samuel S. Reed
Eliza T. Reed

State of Michigan }
County of St. Joseph }

On this 9th day of March 1907 before me a Notary Public in and for said county, personally came Samuel S. Reed and Eliza T. Reed known to me to be the persons who executed the foregoing dedication and who acknowledged the same to be their free act and deed.

L. O. Miller Notary Public
My term expires July 5th 1908.

State of Michigan }
County of St. Joseph } We W. H. Van Buren, Register of Deeds, and Samuel S. Reed, Engineer, hereby certify that we have each carefully compared this copy with the original plat of Bonnie Castle Addition to Three Rivers and that it is an exact copy thereof and of the whole of such original map or plat.

W. H. Van Buren Register of Deeds
Samuel S. Reed Engineer

REGISTER'S OFFICE,
COUNTY OF ST. JOSEPH.
Received for Record, this 17th day of Apr A. D. 1907 at 10 o'clock A. M., and Recorded in Vol. 1 of Plats of Deeds, on Page 44
W. H. Van Buren
Register of Deeds.