

LYMAN'S ADDITION
TO THE VILLAGE OF
MENDON

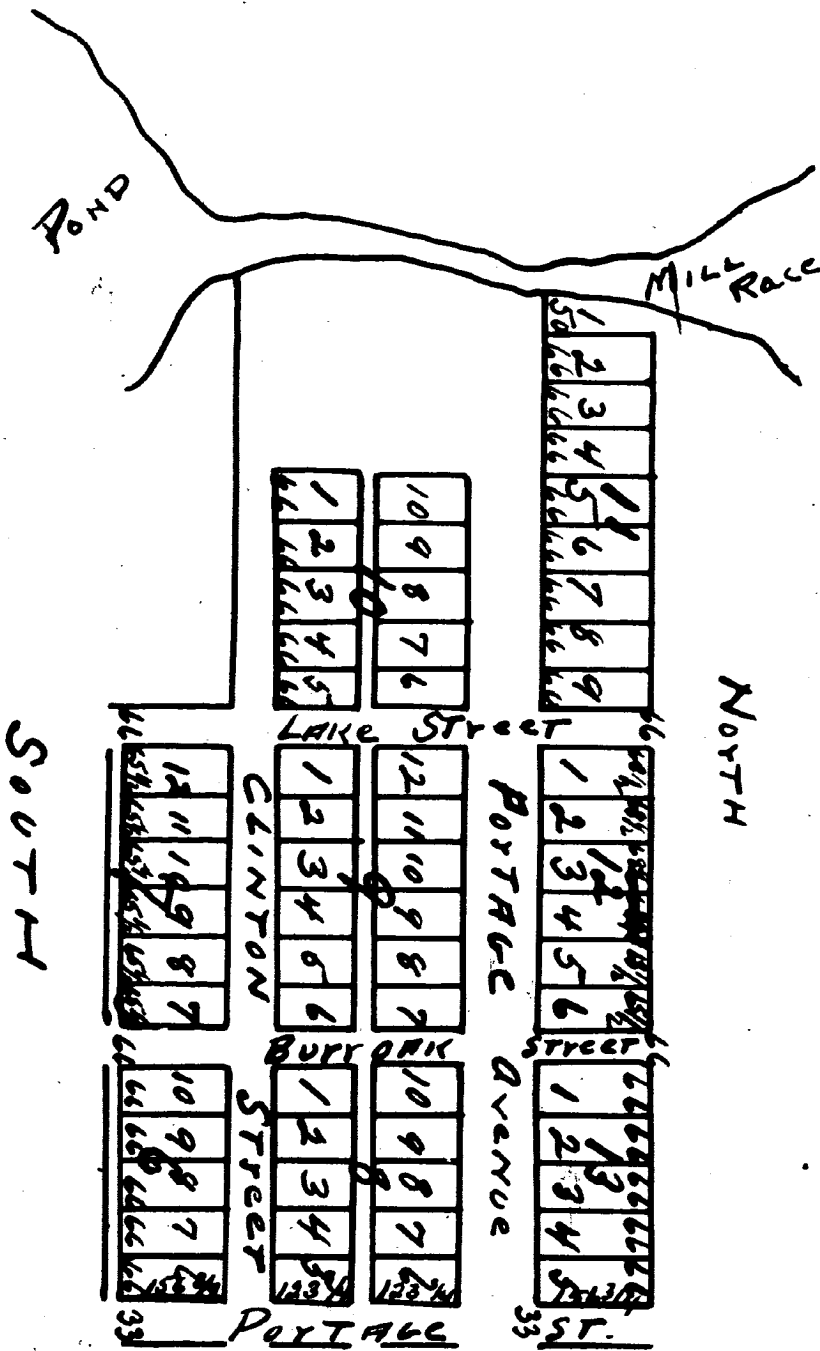

I hereby certify that the plat is a correct copy of the plat now on record in the office of the Register of Deeds of the State of Michigan by the name of the said Lyman. I have compared the original of the said plat with the copy on file in the office of the Register of Deeds of the State of Michigan and find them to be correct. Witness my hand and the seal of the State of Michigan this 19th day of July 1910.

J. B. Warner
Register of Deeds, and ex-officio

Survey of Lyman addition to the village of Mendon made June 1st 1868 being located on the north half of section twenty seven in Township five north of Range ten west County of St. Joseph Michigan. The distance in feet is given on each lot. Streets are four rods wide except Postage Avenue which is six rods wide & Postage street which is 33 feet wide. Allys are one rod wide. I certify that the above is correct.

J. H. Gardner
County Surveyor.

Know all men by these presents that I Lewis B. Lyman of Mendon Michigan Proprietor of the accompanying Plat entitled Lyman's addition to the village of Mendon. Said out & lying next north of & adjoining Marquette & Lyman's addition. do hereby grant and give all streets Avenues & alleys laid out in my said Plat to the Public for Public use agreeably to the statute in such case made & provided. Witness my hand & seal at Mendon this 18th day of Sept 1868.

Lewis B. Lyman (L.S.)

State of Michigan }
St. Joseph County } On this 23rd day of September A.D. 1868 before me a Notary Public in and for said county personally came the above named Lewis B. Lyman known to me to be the person named in & who executed the accompanying Plat and acknowledged the same to be his free act & deed.

Entered for record Sept 24. 1868
at 6 O'clock P.M.

Jes. B. Reed.
Notary Public

L. A. Clapp. Regr.