

PLAT OF EDDY'S ADDITION TO THE VILLAGE OF MENDON

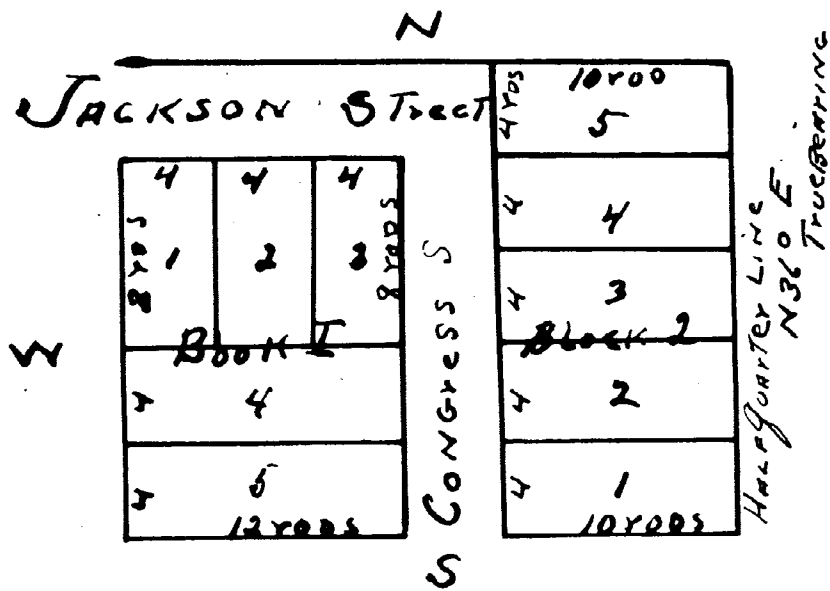

Survey and Plat of Levi Eddy's addition to the Village of Mendon County of St Joseph Mich. Located on the north west quarter of section 26 Township 5 south of Range 10 west. The north west corner of lot one in one is 104 rods south and 5 rods east of the north west corner of the section. Variation is 3° 10' EAST Surveyed October 8th 1866. Lots 1, 2 & 3 in Block one are 4 by 8 rods lots 4 & 5 in Block one are 4 by 12 rods. Lots in Block two are 4 by 10 rods. Streets are 4 rods wide. J. W. Gardner Co. Surveyors.

I Levi Eddy of the Township of Mendon County of St. Joseph and State of Michigan proprietor of the above Plat entitled "Eddy's Addition to the Village of Mendon" do hereby give and dedicate the streets in said Plat to the Public for the use of the Public agreeably to the Statute in such case made and Provided. Witness my hand and seal this 22nd day of October 1866. Levi Eddy (es). S. A. Clapp. A. Clapp.

State of Michigan }
 St Joseph County }
 On this 22nd day of October A. D. 1866 before me a Notary Public in & for said County personally came the above named Levi Eddy known to me to be the person who executed the foregoing instrument and acknowledged the same to be his free act and deed. S. A. Clapp. Notary Public.

Entered for record Oct 22, 1866 at 10 3/4 o'clock. a.m.

I hereby certify that this Plat is a correct copy of the Plat now on record in the Register of Deeds office, being made under the supervision of the Auditor General by tracing the plat on record and affixing thereto a carefully compared copy of the Dedication & Certificate.

Dated this 19th day of July 1910

Ray C. Warner
 Clerk, and Gen. Supt.